

MEIGSVILLE TOWNSHIP SECTION 12 R11 TWP 10 MORGAN COUNTY, OHIO

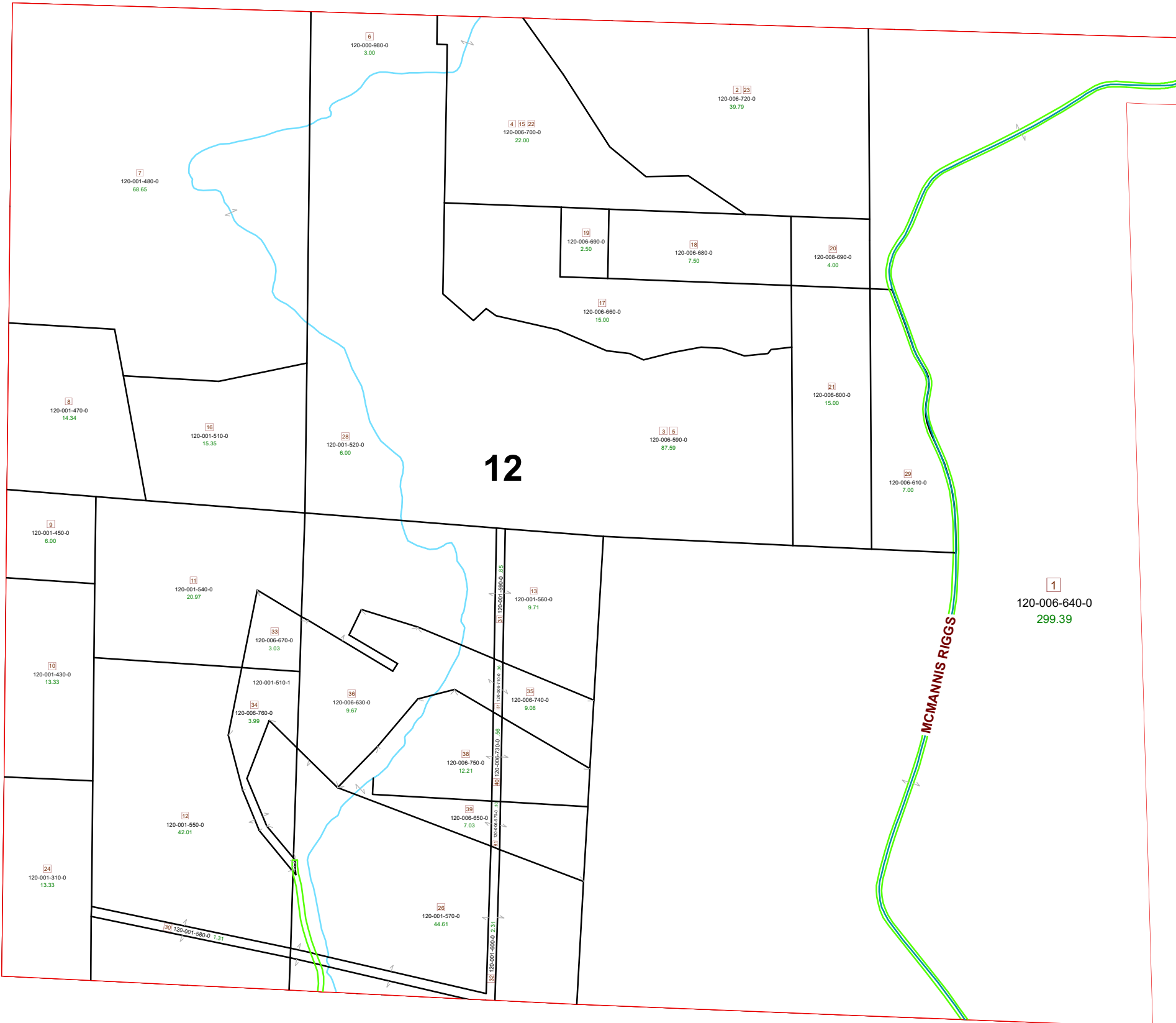

PIN	VOL	PAG	Owner	LegalDescr	Acres
120-001-570-0	OR230	1	CNX LAND LLC	R11 T10 S12 SD 26	44.61
120-001-550-0	OR230	1	CNX LAND LLC	R11 T10 S12 SD 12	42.01
120-001-580-0	OR230	1	CNX LAND LLC	R11 T10 S12 SD 30	1.31
120-001-600-0	OR230	1	CNX LAND LLC	R11 T10 S12 SD 32	2.31
120-006-650-0	OR230	1	CNX LAND LLC	R11 T10 S12 SD 39	7.03
120-006-570-0	OR230	1	CNX LAND LLC	R11 T10 S12 SD 41	0.3
120-001-310-0	OR230	1	CNX LAND LLC	R11 T10 S12 SD 24	13.33
120-006-750-0	OR230	1	CNX LAND LLC	R11 T10 S12 SD 38	12.21
120-006-730-0	OR230	1	CNX LAND LLC	R11 T10 S12 SD 40	0.56
120-006-740-0	OR230	1	CNX LAND LLC	R11 T10 S12 SD 35	9.08
120-006-710-0	OR230	1	CNX LAND LLC	R11 T10 S12 SD 37	0.36
120-006-670-0	OR230	1	CNX LAND LLC	R11 T10 S12 SD 33	3.03
120-001-430-0	OR230	1	CNX LAND LLC	R11 T10 S12 SD 10	13.33
120-001-560-0	OR230	1	CNX LAND LLC	R11 T10 S12 SD 13	9.71
120-001-590-0	OR230	1	CNX LAND LLC	R11 T10 S12 SD 31	0.85
120-001-540-0	OR230	1	CNX LAND LLC	R11 T10 S12 SD 11	20.97
120-001-450-0	OR230	1	CNX LAND LLC	R11 T11 S12 SD 9	6
120-001-510-0	OR230	1	CNX LAND LLC	R11 T10 S12 SD 16	15.35
120-001-470-0	OR230	1	CNX LAND LLC	R11 T10 S12 SD 8	14.34
120-006-610-0	OR230	1	CNX LAND LLC	R11 T10 S12 SD 29	7
120-006-600-0	OR230	1	CNX LAND LLC	R11 T10 S12 SD 21	15
120-006-680-0	OR230	1	CNX LAND LLC	R11 T10 S12 SD 18	7.5
120-006-690-0	OR230	1	CNX LAND LLC	R11 T10 S12 SD 19	2.5
120-006-660-0	OR230	1	CNX LAND LLC	R11 T10 S12 SD 17	15
120-006-720-0	OR230	1	CNX LAND LLC	R11 T10 S12 SD 2-2	39.79
120-006-700-0	OR230	1	CNX LAND LLC	R11 T10 S12 SD 4-2	22
120-001-520-0	OR230	1	CNX LAND LLC	R11 T10 S12 SD 28	6
120-001-480-0	OR230	1	CNX LAND LLC	R11 T10 S12 SD 7 G	68.65
120-006-760-0	OR230	1	CNX LAND LLC	R11 T10 S12 SD 34	3.99
120-006-630-0	OR230	1	CNX LAND LLC	R11 T10 S12 SD 36	9.67
120-006-590-0	OR230	1	CNX LAND LLC	R11 T10 S12 SD 3-5	87.59
120-000-980-0	OR230	1	CNX LAND LLC	R11 T10 S12 SD 6 C	3
120-006-640-0	OR234	3667	OHIO FRANKLIN REALTY LLC	R11 T10 S12 SD 1	299.39
120-008-690-0	OR225	3389	WHITACRE RUSH W & DAVID V	R11 T10 S12 SD 20	4

Boundaries

- Hydro
- Section
- Roads
- Lot
- County
- Parcel
- ROW
- - - Township

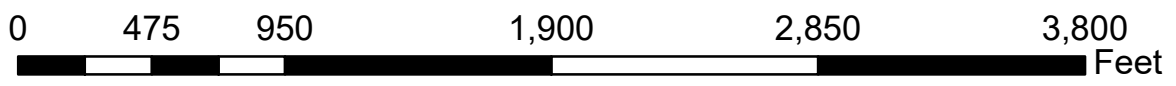

Disclaimer: The information that these maps contains is for reference purposes only. Please bring any erros to the attention of the Engineer's Office staff. Thank you